

CASEY RUTHERFORD THE CREEKSIDE PARK

Birdwatching / Flood Mitigation / Celebrating Heritage

caseyrutherford242@gmail.com
<https://crpdesigns.myportfolio.com/>

This design is focused on the idea of temporality. Water, light and sound are all ever-changing elements that influence how the space is perceived. The design welcomes climatic changes, allowing spaces to flood to create temporary play opportunities and bringing excitement into the landscape through pools and waterfalls. A cycle of wet to dry, the design will provide interest in contrasting climates, giving nature the ability to creep and dominate the creek when the water is gone. In time for events, the open grass meadow can be mown to create pockets of changing spaces, as well as to provide space for entertainment. The inclusion of an outdoor exhibition space and market area will provide the opportunity for DEFRA to expand its indoor displays, providing educational features that promote pro-environmental behaviours to create a greener future for Newark.

1. The Creek
2. A Layered Landscape
3. Space for Water
4. A Connected Community
5. Submerge Into Nature
6. Temporary Play
7. Explore.

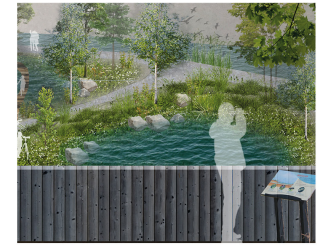
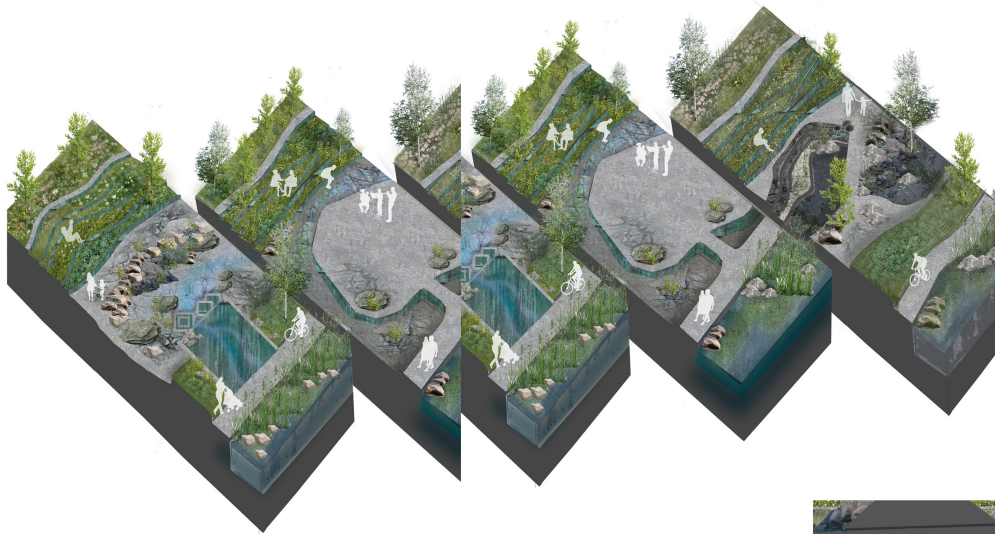

LANDSCAPE AND ECOLOGY

